



Quality
The First
Time

S-LOCK
HIGH STRENGTH BLIND RIVETS

High Strength Blind Rivets S-LOCK

In many industries, riveted connections must meet extremely high requirements. Goebel Group is specializing in development of custom-designed riveting solutions.

The high strength blind rivets S-LOCK feature a double mandrel locking system, flush mandrel break, extensive grip range and high connection stability. Even under dynamic pressure, the high strength blind rivets S-LOCK remain tight.

The rivet mandrel always breaks flush to setting head, even with various material thicknesses if these are within the rivet's grip range. With a properly prepared pre-drilled hole, these rivets are splash-proof and dust-tight.

During the setting process, the distinctive ring is drawn into the rivet body and retained inside. This builds a large closing head that ensures high tensile values.

The high strength rivets S-LOCK can be applied e.g. in vehicle manufacturing and car body construction, trailer and tank construction, in building industry as well as in automotive industry and general industry.



Advantages at a Glance

- Suitable for applications with heavy loads
- Extensive grip range and high clamping force
- Very high shear and tensile values
- Excellent hole bearing performance (splash-proof and dust-tight)
- High vibration resistance
- Mandrel always breaks flush to setting head
- Expands under setting head providing better grip
- Remaining mandrel is retained within the rivet body (without clapping sound)
- Can fix very different material combinations
- Fast, simple and secure handling
- Permanent connection
- No heat sensitive deformation of connected elements
- No extensive finishing work is required
- All-purpose

- 1 Flush mandrel break
- 2 Double mandrel locking system
- 3 Large setting head on the blind side of connection
- 4 Retained remaining mandrel
- 5 Safely locked remaining mandrel

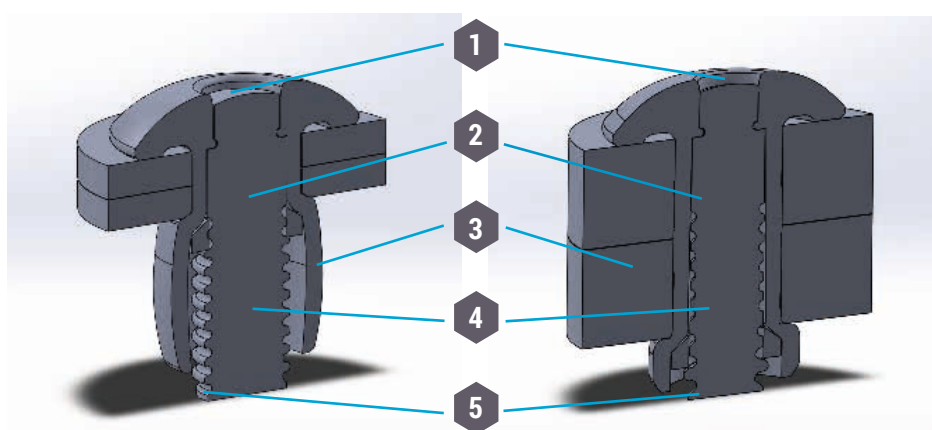

PRODUCT FEATURES

GOEBEL	Mandrel Locking	Grip Range	Closing Head	Vibration Resistance	Leak Tightness	Mandrel Break Performance	Hole Bearing	Set Rivet
HIGH STRENGTH BLIND RIVETS								
S-LOCK	Mechanical mandrel locking (lying inside)	Extensive grip range	Conical closing head	High vibration resistance	Splash-proof and dust-tight	Flush mandrel break	Excellent hole bearing performance	

S-LOCK

DOMED HEAD WITH GROOVED MANDREL
STEEL ZINC PLATED

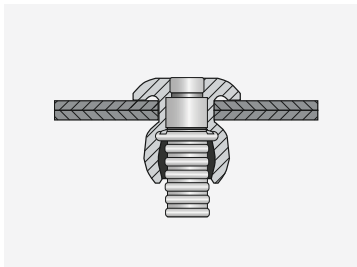
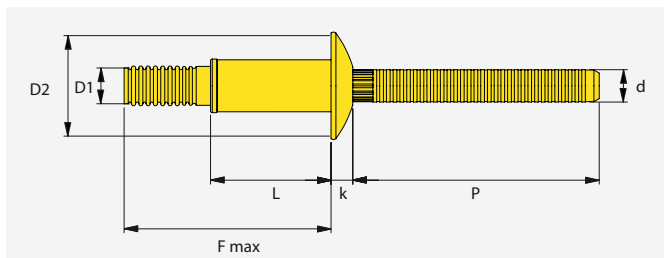

Ø 6,4 mm

D1 = 6,4 + / - 0,05 mm

D2 = 13,0 + 0 / - 0,4 mm

k = 3,0 + / - 0,2 mm

d = 4,0 mm (Ref.)

P = ≥ 28,0 mm

L = + 0 / - 0,6 mm

6,6 - 6,9 mm

D1	F max		CODE	1)	1)	1)	GOBEL	GOBEL
6,4 x 14,5 mm	27,0 mm	2,2 - 9,5 mm	78100 64140	15500 N	8400 N	1750 N	250	2500
6,4 x 20,8 mm	33,0 mm	9,5 - 15,8 mm	78100 64200				250	2500

1) typical values

SETTING TOOLS FOR HIGH STRENGTH BLIND RIVETS

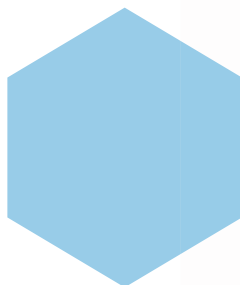

AIRPOWER 3

PNEUMATIC-HYDRAULIC
RIVETING TOOL

Weight	2,0 kg
L x H	282 x 294 mm
Material	ABS
Stroke	28 mm
Air Consumption / Stroke	5,0 Liter
Working Pressure	5 - 7 bar
Tractive Power	16,5 kn (6,0 bar)
Hose Connector	6 mm
Nosepiece Adaptor	Ø 22,5 mm
Code	22440 00003

AKKU-TOOL GO-200

ELECTROMECHANIC WIRELESS
RIVETING TOOL

Weight	1,70 kg
L x H	273 x 285 mm
Material	PE
Stroke	27 mm
Tractive Power	18.000 N
Nosepiece Adaptor	Ø 23,5 mm
Code	22660 20006

Above mentioned tools can be found in our Riveting Tools Catalogue, pages 7 and 13.